

Never hang or carry the pump by the power cord.
Do not operate the pump with a damaged cord or plug. The supply cord of the appliance cannot be replaced.

If the electrical cord is damaged the product should be scrapped.

Safety and Electrical Connections

This unit is designed for outdoor use only. It is waterproof and should be situated safely under the pond water. Ideally the pump should be situated at the bottom of the pond as this is where fish waste and debris collects. Take care to ensure that you can easily lift your pump out of the water for routine maintenance. If this is necessary do not pick your pump up by the electrical cable but by the main body/cage of the pump.

Always disconnect all equipment in the pond before starting to handle, maintain, repair or install any pond equipment.

The pump is electrically operated so great care must be taken during installation and operation. The following electrical and safety guidelines must be carefully followed.
Each pump is supplied with a 10 metre length of 3 core electrical cable which is permanently connected to the pump.

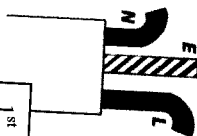

The wires in the mains electrical lead are coloured in accordance with the following code:
BLUE – Neutral (marked with an “N” in most terminal connections)
BROWN – LIVE (marked with an “L” in most terminal connections)
GREEN/YELLOW – EARTH (marked “E” or  in most terminal connections)

1st January 2005 revised Building Regulations for England and Wales
Installing this product in the garden is classified as ‘notifiable’. The Regulations now require you to tell your local authority building control department that you intend to install this product before installation. Your local authority will let you know how you can get your installation approved

The termination to the mains supply should be permanent, inside a dry weatherproof enclosure, through a double pole switched fused spur with a minimum contact gap of 3mm – (disconnected) to BS 3676 – and fitted with a 3 or 5 amp fuse.
Exposed cable runs should be sensibly positioned, and protected if necessary by armoured conduit.

A 10mA or 30mA Residual Current Circuit Breaker (RCD) MUST be fitted to the mains supply.

Permanent installations to the mains supply (hard wiring) must comply with the regulations of the local electricity authority which may stipulate the use of metal or plastic conduit to protect the cable.

If in any doubt about wiring to the mains supply contact a qualified electrician or your local electricity authority.

Protect from frost. In cold winter weather (when fish are inactive and algae growth ceases) the unit may be switched off. It should then be drained of water, removed (if possible) from its installation and stored in a dry, frost-protected area.

Directions for use

Installation

Once installed the pond water will flow through the pump as the pump’s impellor draws in water. It is always best to position your pump at the opposite end to where the water returns to the pond to provide maximum circulation.

Your pond is supplied with a hoseetail. This should be screwed into the threaded pump inlet. Pond hose size 25-40mm (1” to 1 3/4”) can be attached to the inlet hoseetail. Cut the inlet hose to the size appropriate to the size of hose you are using. Then connect the hose from your pump to your filter system or position it where you want the water to return. Ensure a watertight seal by the use of hoseclips.

Submerge the pumps completely in your pond so as to make the pump body fill with water. A water level of approx. 15 cm (6 in.) is required for submersible use in order to prevent the pump from taking in air.

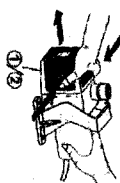

Fig. 1

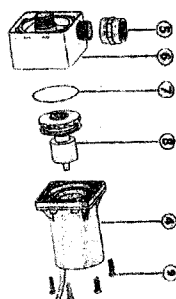

Fig. 2



Fig. 3

Maintenance and cleaning (see fig. 1 and 2)

1. Follow these safety instructions. Make sure that the pump is unplugged.
2. Press the filter cover (1) together laterally and take it from the pump housing (6).
3. Loosen the 4 outer screws (9).
4. Unclip the pump housing (6) from motor housing (4).
5. Remove the rotor (8) from motor housing (4).
6. Clean all parts using water and soft sponge.

Fountain Connector

Your pump may be supplied with a threaded plastic ‘nut’. This is a connector to join to a fountain kit (sold separately)

Assembling the pump together:

- Place the rotor (8) in motor housing (4) with caution.
- Make sure the rotor is assembled correctly and will turn freely and check the position of the sealing ring (7) on the pump housing (6).
- Put the pump housing (6) in the motor housing (4) and tighten the 4 screws (9) uniformly.

Place the filter cover on the pump housing (6). Make sure that the lateral lugs of the filter cover must lock the pump housing (6).

Maintenance